

RCP

LOAD CELL SERIES RCP



Compression load cell for CE-M approved weighbridges, tanks, silos, etc. Complete execution in steel, and fitted with selfaligned articulated joints, selfcentering plates and protection washer.

CAPACITIES (kg): 30000, 50000.

Stainless steel with alloy steel body. IP68 protection. C3 precision class.

Working in cooperation with:

VAHY PRO S.R.O.

FUGNEROVA 345 - 40004 - TRMICE
Tel. 0042-0475620800 Fax. 0042-0475620800
vahypro@vahypro.cz

The best solution
for advanced industrial
applications

MAIN FEATURES

- C3 PRECISION CLASSES.
- STAINLESS STEEL with SPECIAL ALLOY STEEL BODY; EXECUTION WITH LASER SOLDERINGS.
- OPTIMISED FOR PARALLEL CONNECTION.
- IP68 PROTECTION DEGREE.
- CAPACITY FROM 30000 TO 50000 kg.
- FITTED WITH SELFALIGNED ARTICULATED JOINTS, SELF-CENTERING PLATES AND PROTECTION WASHER.
- SHIELDED 14m CONNECTION CABLE.
- TEST CERTIFICATE AVAILABLE UPON REQUEST.

TECHNICAL FEATURES

- Minimum load cell verification interval: $V_{min} = E_{Max} / 10.000$
- Maximum number of load cell divisions: $n_{LC} = 3000$ (C3)
- Sensitivity: $2mV/V \pm 0,1\%$
- Temperature effect on full scale: $0,002\% / ^\circ C$
- Temperature effect on zero: $0,002\% / ^\circ C$
- Compensated Temperature Range: $-10^\circ C / +40^\circ C$
- Operating Temperature Range: $-30^\circ C / +70^\circ C$
- Creep error after 30 minutes: $0,02\%$ F.S.
- Excitation voltage from 5 to 15 VDC
- Input Resistance: 700 ± 20 Ohm
- Output Resistance: 703 ± 7 Ohm
- Zero Balance: $\pm 1\%$ F.S.
- Insulation Resistance: >5000 MOhm
- Safe Overload: $>150\%$ F.S.
- Ultimate Overload: 250% F.S.
- 4-wire shielded cable, 14m long, 5mm diameter.

ATEX Version

- The CCATEX certificate makes the load cell suitable for use in hazardous areas with protection methods according to:
ATEX II 1G Ex ia IIC T6 (Ta $-20 \div +40^\circ C$) TX (Ta $-20 \div +65^\circ C$) Ga
ATEX II 1D Ex ta IIIC TX $^\circ C$ (Ta $-20 \div +40^\circ C$) TX $^\circ C$ (Ta $-20 \div +65^\circ C$) Da IP65.
The certificate includes the manual and the ATEX CE conformity declaration (available in EN, DE, FR, and IT).
- IMPORTANT: the certificate refers to the single load cell. For systems with more load cells, it is necessary to order one certificate for each load cell.

Wiring Code	
Colour	Function
GREEN	OUTPUT +
WHITE	OUTPUT -
RED	INPUT +
BLACK	INPUT -

DETAIL 1

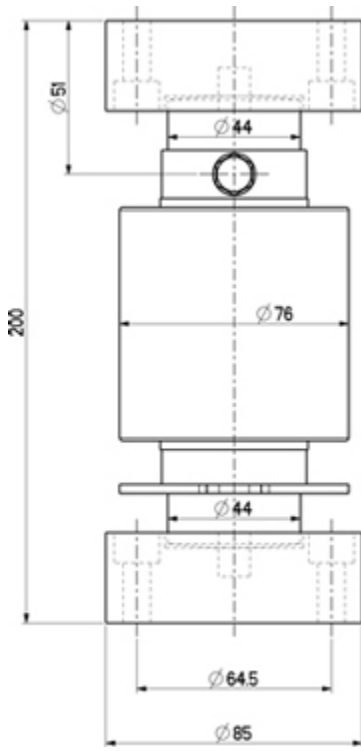

RCP: dimensions in mm.

VERSIONS

AVAILABLE VERSIONS

Code	Max (kg)	Masterpack 4 pcs
RCP30C3	30000	RCP30C3C
RCP50C3	50000	RCP50C3C



www.diniargeo.com



“YOUR WORLDWIDE PARTNER FOR WEIGHING,”

DINI AR GEO
FRANCE sarl
Nogent-sur-Marne

DINI AR GEO
GMBH
Sinsheim - Germany

DINI AR GEO
UK Ltd
Taunton - United Kingdom

DINI AR GEO WEIGHING
INSTRUMENTS Ltd
Shanghai - China

DINI AR GEO
WEIGHBRIDGES
Calto (RO) – Italy



HEAD OFFICE
Via Della Fisica, 20
41042 Spezzano di Fiorano Modena - Italy



VAHY PRO S.R.O.

FUGNEROVA 345 - 40004 - TRMICE

Tel. 0042-0475620800 Fax. 0042-0475620800

vahypro@vahypro.cz

SALES AND TECHNICAL ASSISTANCE SERVICE