

## STG

### STG SERIES TENSION LOAD CELLS

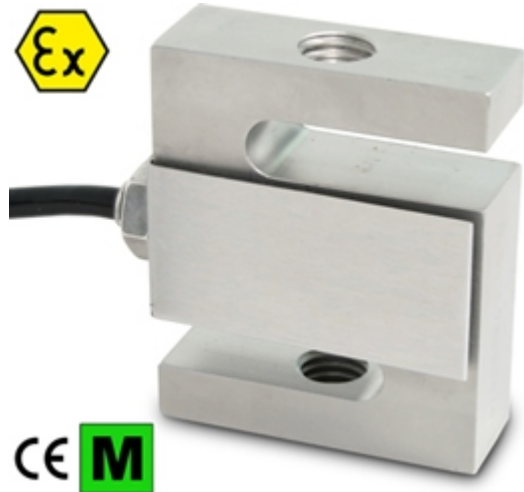

Tension or Compression approved load cells for the weighing hoppers, tanks, scales with levers, and with other weighing devices.

---

CAPACITIES (kg): 100, 500, 1000.

---

17-4 PH stainless steel. IP67 protection. C3 precision class.

---

Working in cooperation with:

**VAHY PRO S.R.O.**

FUGNEROVA 345 - 40004 - TRMICE  
Tel. 0042-0475620800 Fax. 0042-0475620800  
vahypro@vahypro.cz

The best solution  
for advanced industrial  
applications

## MAIN FEATURES

- C3 PRECISION CLASS
- 17-4 PH STAINLESS STEEL CONSTRUCTION
- IP67 PROTECTION
- MAX. CAPACITIES FROM 100 TO 1000 kg
- SHIELDED CONNECTION CABLE
- TEST CERTIFICATE AVAILABLE UPON REQUEST

## TECHNICAL FEATURES

- Minimum load cell verification interval:  
 $V_{min} = E_{Max} / 10.000$  (for STG500 and STG1000 model);  
 $V_{min} = E_{Max} / 7.000$  (for STG100 model)
- Maximum number of verification intervals:  $n_{LC} = 3000$
- Combined error 0,03% of Full Scale Output (F.S.)
- Non-Repeatability: 0,01% F.S.
- Full Scale Output: 3mV/V +/- 0,08%
- Temperature effect on zero: 0,017% /°C
- Temperature effect on full scale output: 0,014% /°C
- Compensated Temperature Range: -10°C/+40°C
- Operating Temperature Range: -35°C/+65°C
- Creep error after 30 minutes: 0,02% F.S.
- Maximum tolerated excitation voltage: 18 VDC
- Input Resistance: 430 ± 60 Ohm
- Output Resistance: 350 ± 3.5 Ohm
- Zero balance: +/-1% F.S.
- Insulation Resistance: >5000 MOhm
- Safe Overload: 150% F.S.
- Ultimate Overload: 300% F.S.
- 4-wire shielded cable, 6m long, 5 mm diameter

## ATEX VERSION

- The CCATEX certificate makes the load cell suitable for use in hazardous areas with protection methods according to:  
ATEX II 1G Ex ia IIC T6 (Ta -20÷+40°C) TX (Ta -20÷+65°C) Ga  
ATEX II 1D Ex ta IIIC TX°C (Ta -20÷+40°C) TX°C (Ta -20÷+65°C) Da IP65.  
The certificate includes the manual and the ATEX CE conformity declaration (available in EN, DE, FR, and IT).
- **IMPORTANT:** the certificate refers to the single load cell. For systems with more load cells, it is necessary to order one certificate for each load cell.

## DETAIL 1

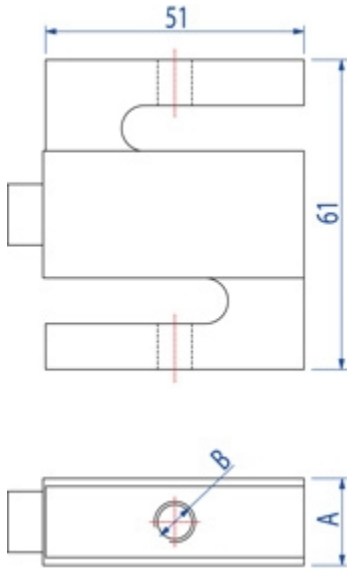

Code	Dimensions in mm	
	A	B
STG100	15	M8
STG500	21	M12
STG1000	28	M12

Wiring Code	
<i>Colour</i>	<i>Function</i>
--	SHIELD
GREEN	OUTPUT +
RED	INPUT +
WHITE	OUTPUT -
BLACK	INPUT -

## VERSIONS

### Models available

Code	Max (kg)	Masterpack 4 pcs
STG100	100	STG100C
STG500	500	STG500C
STG1000	1000	STG1000C



www.diniargeo.com



“YOUR WORLDWIDE PARTNER FOR WEIGHING,”

**DINI ARGEO**  
**FRANCE sarl**  
Nogent-sur-Marne

**DINI ARGEO**  
**GMBH**  
Sinsheim - Germany

**DINI ARGEO**  
**UK Ltd**  
Taunton - United Kingdom

**DINI ARGEO WEIGHING**  
**INSTRUMENTS Ltd**  
Shanghai - China

**DINI ARGEO**  
**WEIGHBRIDGES**  
Calto (RO) – Italy



**HEAD OFFICE**  
Via Della Fisica, 20  
41042 Spezzano di Fiorano Modena - Italy



**VAHY PRO S.R.O.**

FUGNEROVA 345 - 40004 - TRMICE

Tel. 0042-0475620800 Fax. 0042-0475620800

vahypro@vahypro.cz

SALES AND TECHNICAL ASSISTANCE SERVICE